

# ONEFORSTREET 5

LIGHT

LIVE

LASTING

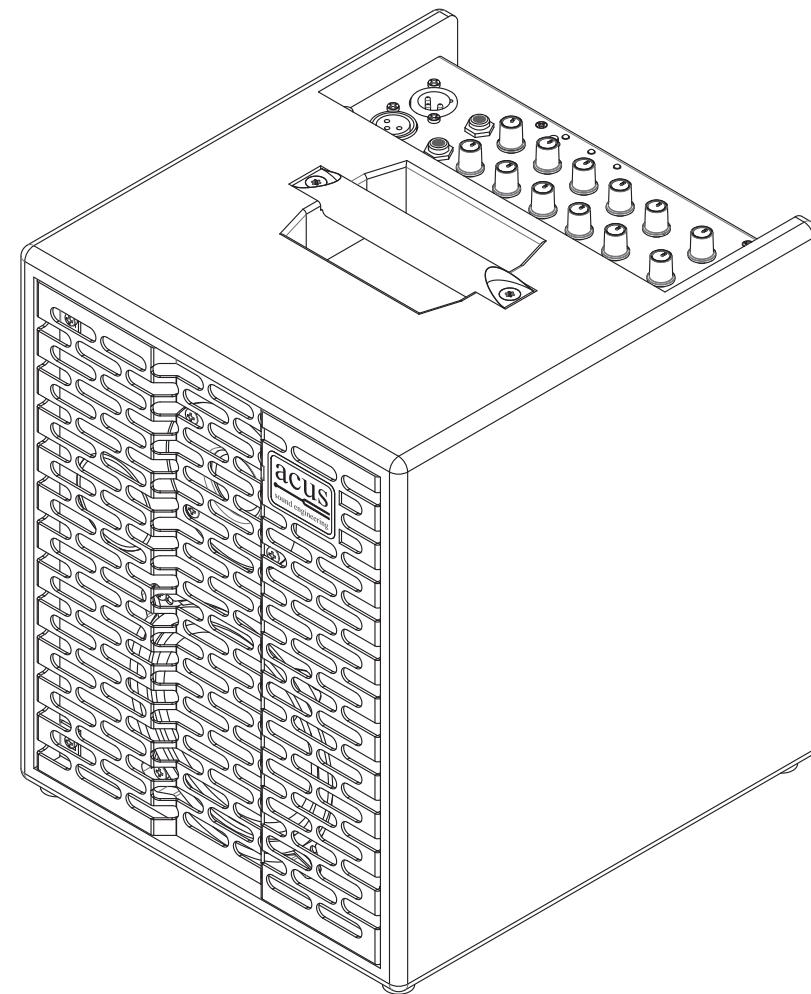

## TECHNICAL INFORMATION

Frequency Response:	50Hz - 20kHz
Max Power Out:	40W
System Format:	2 way Amp
Woofer Power:	30W
Tweeter Power:	10W
Construction:	Brich Plywood Cabinet
Weight:	7 kg
Dimensions (WxHxD)	253x305x280 mm



### N.B.

For more information you can download the complete ONEFORSTREET 5 manual from the company web site.

## POWER SUPPLY

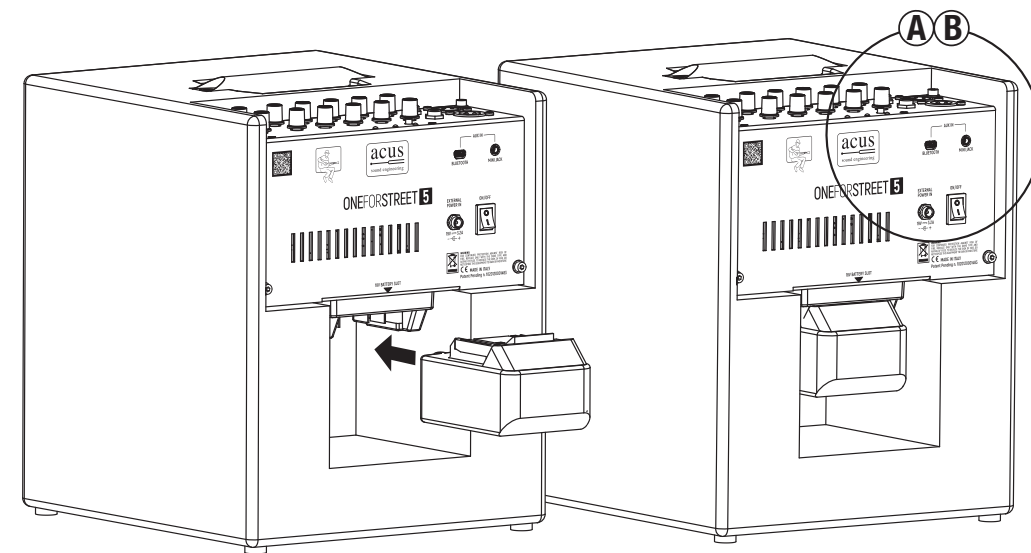

ONEFORSTREET 5 is not equipped with an inner power supply system. Is possible to power it with 2 types of source:

1. Battery (not included): insert the battery in the dedicated sled.
2. External Power Supply (included): connect the power supply to the relative connector.

### COMPATIBILITY:

ACUS Sound Engineering SRL suggest the use of MAKITA 18V- 3 or 5 Ah.

### BATTERY POWERING:

The system has 4 operative status:

1. Battery Full: Battery Status LED (9) is OFF
2. Slightly Discharged Battery Status: Battery Status LED (9) starts to flash. In this status the LED ON Time is about 1/3 of LED Time OFF.
3. Very Low Battery Status: Battery Status LED (9) ON Time is the same of Time ON.
4. Completely Discharged Battery Status: Battery Status LED (9) if always ON and the system stops to work. In this status is necessary to replace the battery with another one full.



### WARNING:

1. Is important to recharge the battery as soon as possible.
2. Avoiding to let the ON/OFF Switch (14) when the system is not used because the system continues to absorb energy.
3. Avoid to let a totally discharged battery inserted because the system absorbs a very little quantity of energy even with the ON/OFF Switch in the OFF position, and this fact (for a long time) will put the battery in a very low discharged status, reducing the battery life.

### EXTERNAL POWER SUPPLY POWERING.

The system works always in "Battery Full" status, so Battery Status LED (9) is always OFF.

### WARNING:

Is not possible to recharge a battery with the amplifier power supply.

## TOP SECTION

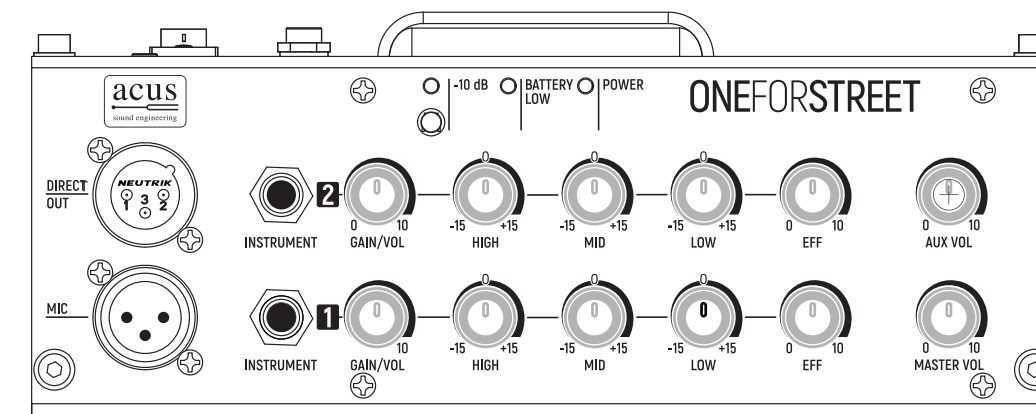

1. **MIC IN** with 1kΩ of Impedance. You can connect any type of microphone on it, even Condenser Microphone (this input is equipped with a Phantom power, always Active).
2. **INSTRUMENT IN** with 110kΩ of Impedance. You can connect any type of Instrument on it. This input doesn't exclude the MIC IN (1).
3. **GAIN / VOL**: this knob permits to regulate the gain and the volume of the system (its range is from  $-\infty$  to +20dB). Moving this knob to the minimum (0 position) puts the volume of the channel to 0. Moving it to the maximum (10 position) put the signal level to +20dB.
4. **HIGH - MID - LOW**: 3 band EQ with a dynamic from -15dB to +15dB.
5. **EFF**: channel Effect Level. The system is equipped with a fixed length Reverb. With this knob is possible to regulate this Reverb Level for the channel
6. **MASTER VOL**: Master Volume of the system.
7. **AUX VOL**: AUX IN (12) Inputs Volume.
8. **Power**: LED for indicating if the system is ON (Led ON) or OFF.
9. **Battery status**: LED for indicating the External Battery Status.
10. **-10dB**: pushing this switch will reduce the DIRECT OUT (11) signal level of 10dB. This attenuation condition is indicated with a LED.
11. **DIREC OUT**: balanced output for connecting the system with an External System.

## REAR SECTION

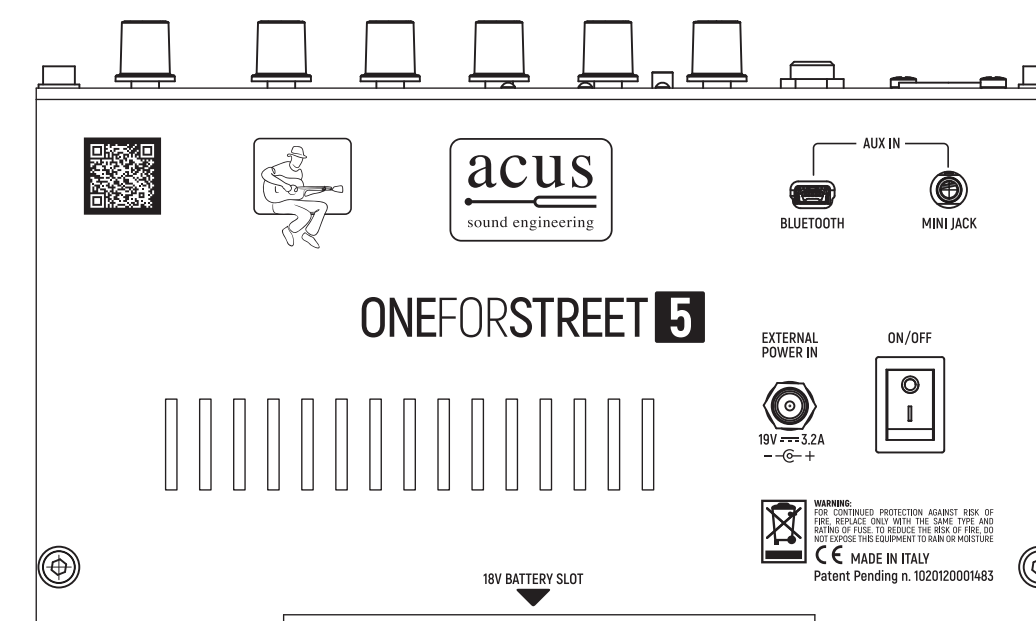

12. **AUX IN**: section with 2 Inputs: a 3.5mm Jack and a mini-USB for Acus Artesia BT-1 device. Both inputs are controlled with AUX VOL (7) knob.
13. **EXTERNAL POWER IN**: connector for the External Power Supply (Included).
14. **ON/OFF**: Power Switch for Turning-ON / OFF the system.
15. **18V BATTERY SLOT**: slot connection for powering the system with the external battery (not included).

## SMART ACCESSORIES

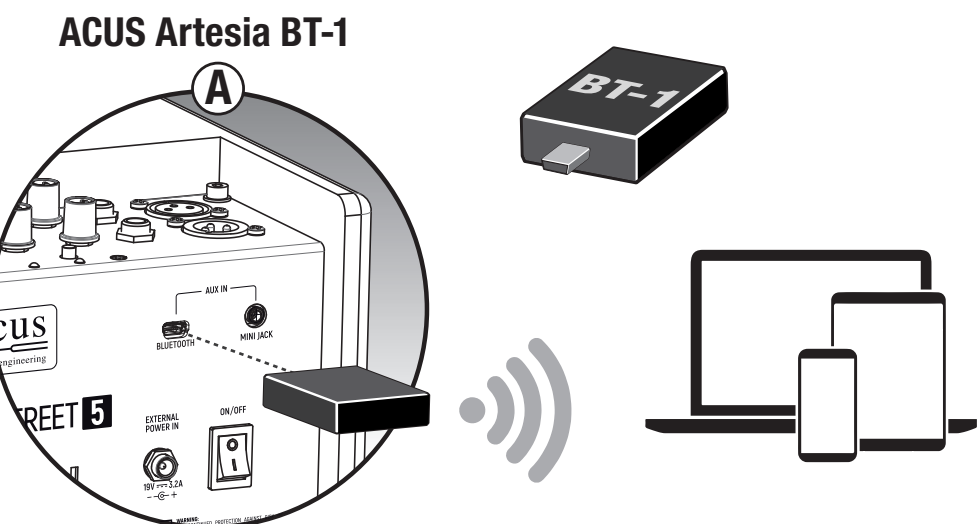

1. Make sure that the amplifier is powered off and connect the ACUS Artesia BT-1 Bluetooth Receiver to mini-USB AUX IN connector.
2. Turn the amplifier on. The ACUS Artesia BT-1 Bluetooth Receiver blue LED indicator lamp should flash quickly. This lasts for about 5 seconds. Then it will flash again every 7 seconds until it matches (or pair) successfully with another Bluetooth device.
3. After it has matched successfully, find ACUS Artesia BT-1 as an option on your Bluetooth Device's Settings and then select it to connect.
4. When the blue LED Indicator lamp on the ACUS Artesia BT-1 Bluetooth Receiver is ON steady with no flashing, then the two devices have been successfully connected.

### ACUS Artesia LS-1 - TRRS ADAPTER for your live streaming

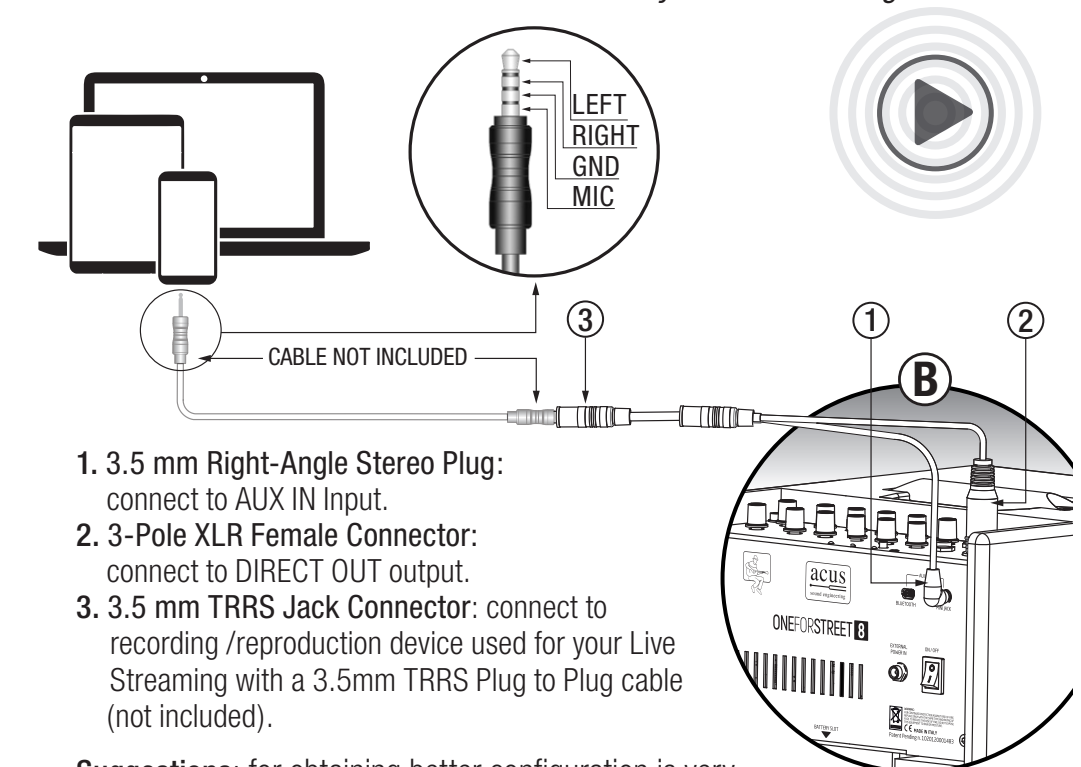

1. 3.5 mm Right-Angle Stereo Plug: connect to AUX IN Input.
2. 3-Pole XLR Female Connector: connect to DIRECT OUT output.
3. 3.5 mm TRRS Jack Connector: connect to recording /reproduction device used for your Live Streaming with a 3.5mm TRRS Plug to Plug cable (not included).

**Suggestions:** for obtaining better configuration is very important to have a moderate volume to the amplifier DIRECT OUT output. If the amplifier is equipped with the attenuation switch (labeled with -10dB) push this switch for a very easy and fast signal level matching. If the amplifier is not equipped with this switch, for best configuration please reduce all channel volume more than half and then regulate the amplifier master volume for obtaining the right sound to the speaker.

# ONEFORSTREET 8

LIGHT

LIVE

LASTING

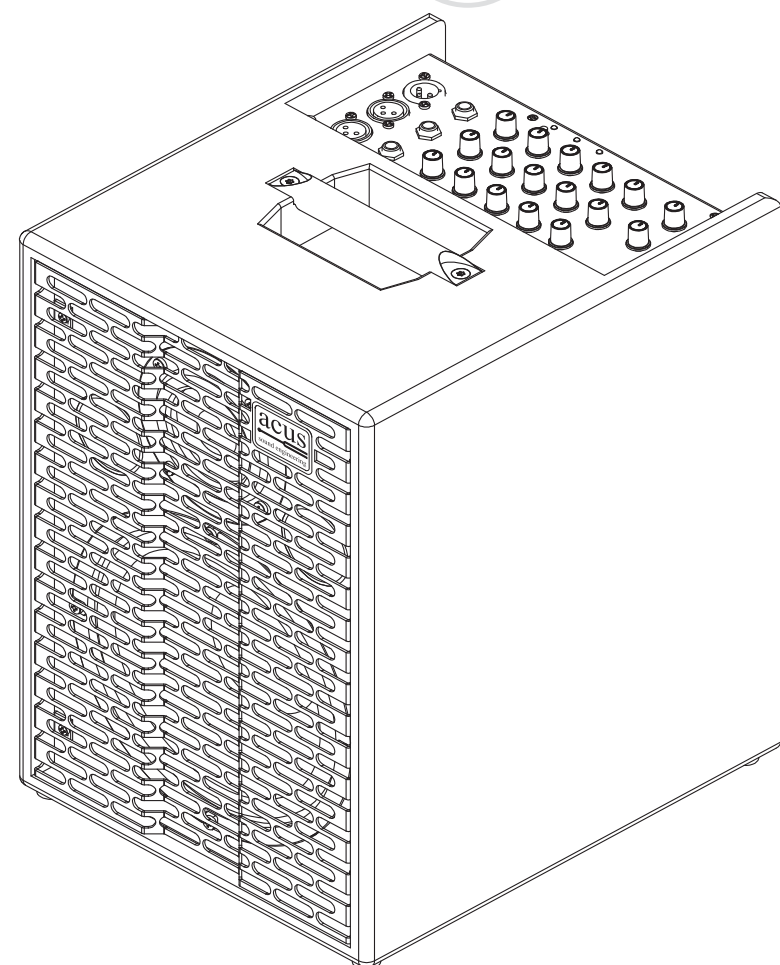

## TECHNICAL INFORMATION

Frequency Response: 40Hz - 20kHz  
 Max Power Out: 90W  
 System Format: 2 way Amp  
 Woofer Power: 60W  
 Tweeter Power: 30W  
 Construction: Birch Plywood Cabinet  
 Weight: 9,5 kg  
 Dimensions (WxHxD): 263x384x310 mm

### N.B.

For more information you can download the complete ONEFORSTREET 8 manual from the company web site.

## POWER SUPPLY

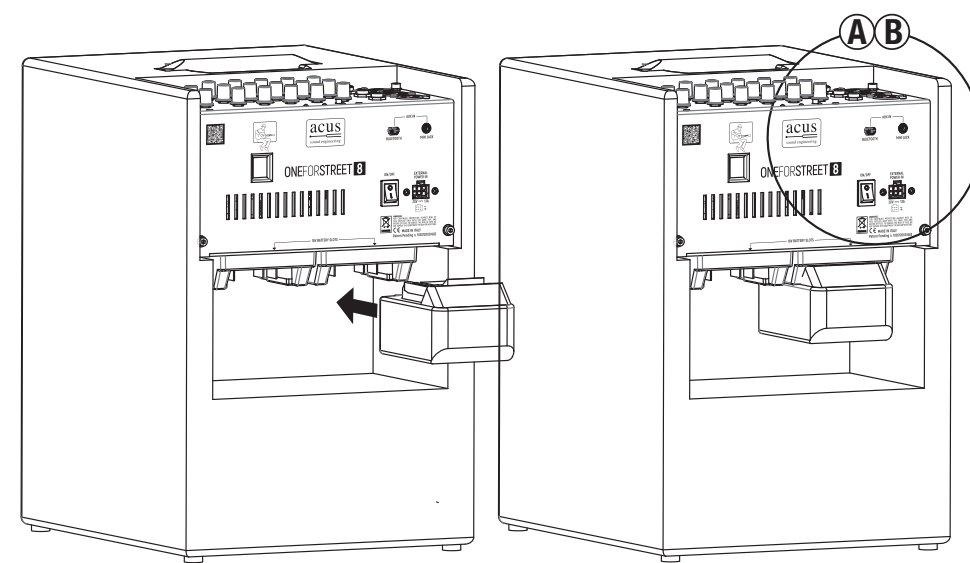

ONEFORSTREET 8 is not equipped with an inner power supply system. Is possible to power it with 2 types of source:

1. Battery (not included): insert the battery in the dedicated sled
2. External Power Supply (included): connect the power supply to the relative connector.

### COMPATIBILITY:

ACUS Sound Engineering SRL suggest the use of MAKITA 18V- 3 or 5 Ah.

### BATTERY POWERING:

The system has 4 operative status:

1. Battery Full: Battery Status LED (9) is OFF
2. Slightly Discharged Battery Status: Battery Status LED (9) starts to flash. In this status the LED ON Time is about 1/3 of LED Time OFF.
3. Very Low Battery Status: Battery Status LED (9) ON Time is the same of Time ON.
4. Completely Discharged Battery Status: Battery Status LED (9) if always ON and the system stops to work. In this status is necessary to replace the battery with another one full.

### WARNING:

1. Is important to recharge the battery as soon as possible.
2. Avoiding to let the ON/OFF Switch (14) when the system is not used because the system continue to absorb energy.
3. Avoid to let a totally discharged battery inserted because the system adsorbs a very little quantity of energy even with the ON/OFF Switch in the OFF position, and this fact (for a long time) will put the battery in a very low discharged status, reducing the battery life.

### EXTERNAL POWER SUPPLY POWERING.

The system works always in "Battery Full" status, so Battery Status LED (9) is always OFF.

### WARNING:

Is no possible to recharge a battery with the amplifier power supply.

## TOP SECTION

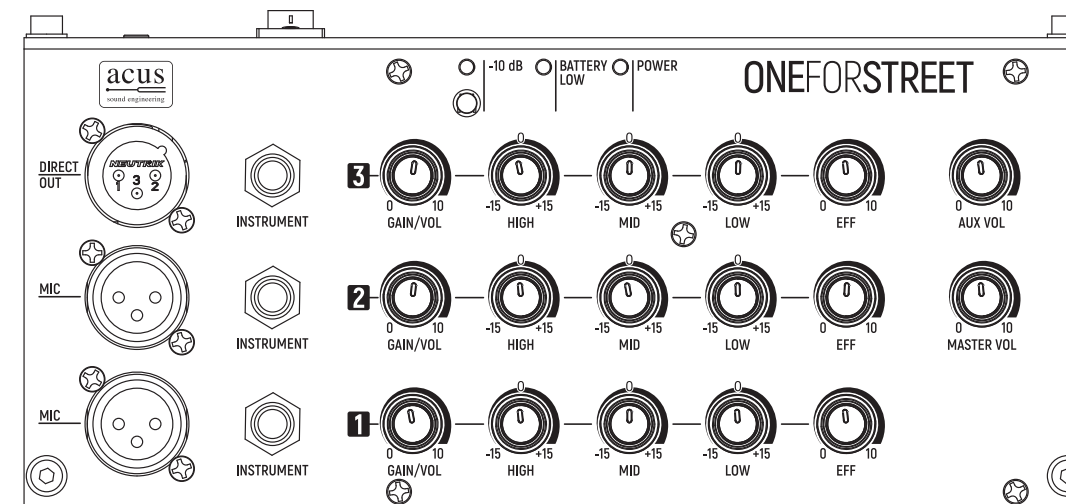

1. **MIC IN** with 1kΩ of Impedance. You can connect any type of microphone on it, even Condenser Microphone (this input is equipped with a Phantom power, always Active).
2. **INSTRUMENT IN** with 110kΩ of Impedance. You can connect any type of Instrument on it. This input doesn't exclude the MIC IN (1).
3. **GAIN / VOL**: this knob permits to regulate the gain and the volume of the system (its range is from -∞ to +20dB). Moving this knob to the minimum (0 position) puts the volume of the channel to 0. Moving it to the maximum (10 position) put the signal level to +20dB.
4. **HIGH - MID - LOW**: 3 band EQ with a dynamic from -15dB to +15dB.
5. **EFF**: channel Effect Level. The system is equipped with a fixed length Reverb. With this knob is possible to regulate this Reverb Level for the channel
6. **MASTER VOL**: Master Volume of the system.
7. **AUX VOL**: AUX IN (12) Inputs Volume.
8. **Power**: LED for indicating if the system is ON (Led ON) or OFF.
9. **Battery status**: LED for indicating the External Battery Status.
10. **-10dB**: pushing this switch will reduce the DIRECT OUT (11) signal level of 10dB. This attenuation condition is indicated with a LED.
11. **DIREC OUT**: balanced output for connecting the system with an External System.

## REAR SECTION

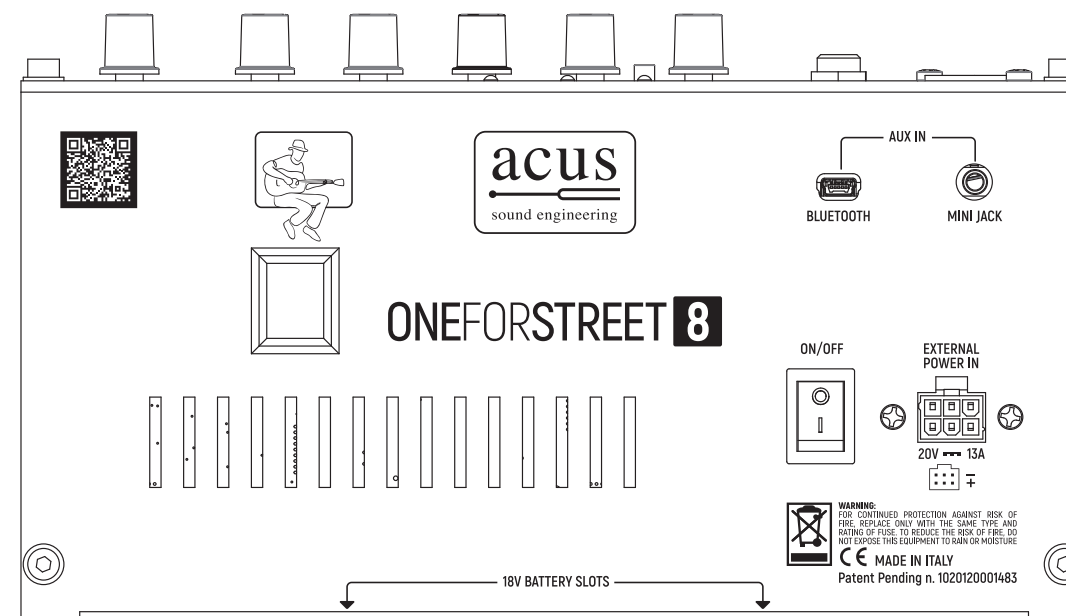

12. **AUX IN**: section with 2 Inputs: a 3.5mm Jack and a mini-USB for Acus Artesia BT-1 device. Both inputs are controlled with AUX VOL (7) knob.
13. **EXTERNAL POWER IN**: connector for the External Power Supply (Included).
14. **ON/OFF**: Power Switch for Turning-ON / OFF the system.
15. **18V BATTERY SLOTS**: slot connection for powering the system with the external battery (not included).

## SMART ACCESSORIES

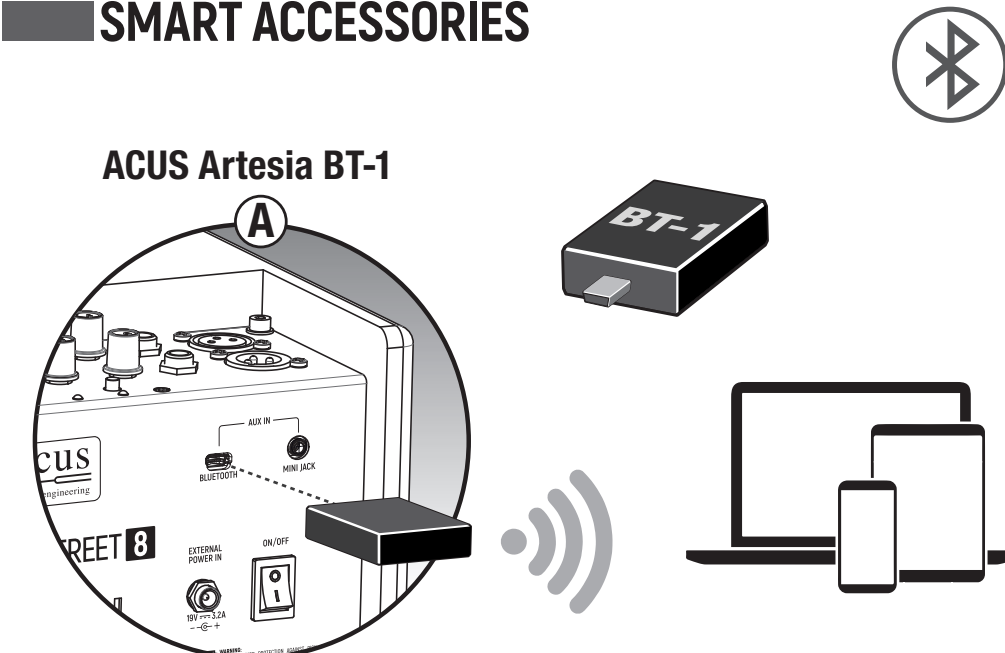

1. Make sure that the amplifier is powered off and connect the ACUS Artesia BT-1 Bluetooth Receiver to mini-USB AUX IN connector.
2. Turn the amplifier on. The ACUS Artesia BT-1 Bluetooth Receiver blue LED indicator lamp should flash quickly. This lasts for about 5 seconds. Then it will flash again every 7 seconds until it matches (or pair) successfully with another Bluetooth device.
3. After it has matched successfully, find ACUS Artesia BT-1 as an option on your Bluetooth Device's Settings and then select it to connect.
4. When the blue LED Indicator lamp on the ACUS Artesia BT-1 Bluetooth Receiver is ON steady with no flashing, then the two devices have been successfully connected.

### ACUS Artesia LS-1 - TRRS ADAPTER for your live streaming

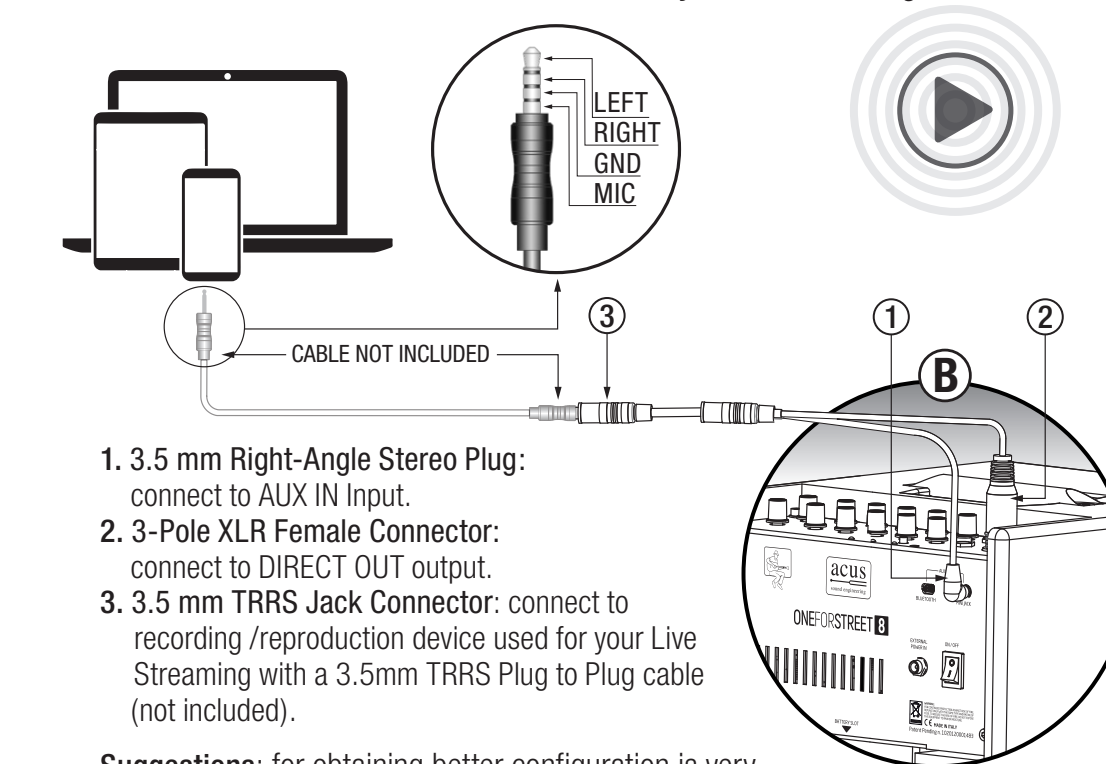

1. **3.5 mm Right-Angle Stereo Plug**: connect to AUX IN Input.
2. **3-Pole XLR Female Connector**: connect to DIRECT OUT output.
3. **3.5 mm TRRS Jack Connector**: connect to recording /reproduction device used for your Live Streaming with a 3.5mm TRRS Plug to Plug cable (not included).

**Suggestions:** for obtaining better configuration is very important to have a moderate volume to the amplifier DIRECT OUT output. If the amplifier is equipped with the attenuation switch (labeled with -10dB) push this switch for a very easy and fast signal level matching. If the amplifier is not equipped with this switch, for best configuration please reduce all channel volume more than half and then regulate the amplifier master volume for obtaining the right sound to the speaker.

# ONEFORSTREET 10

LIGHT LIVE LASTING

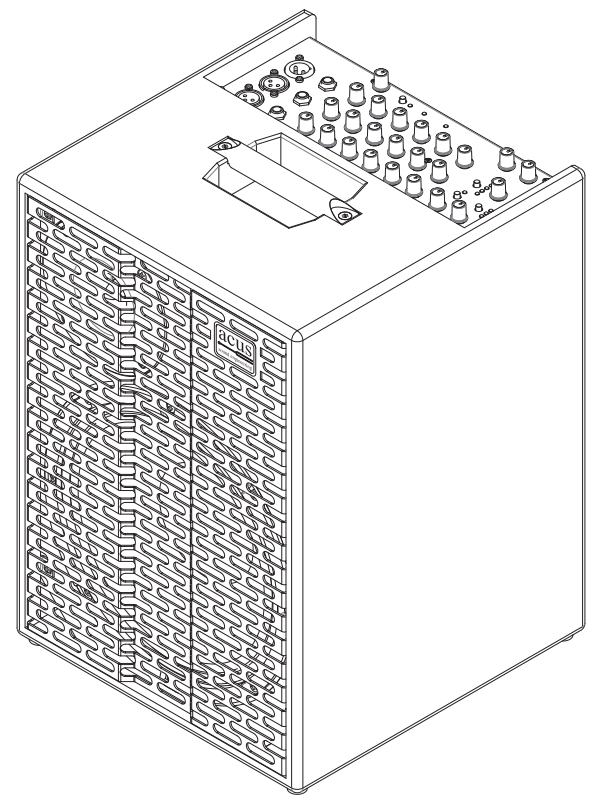

## POWER SUPPLY

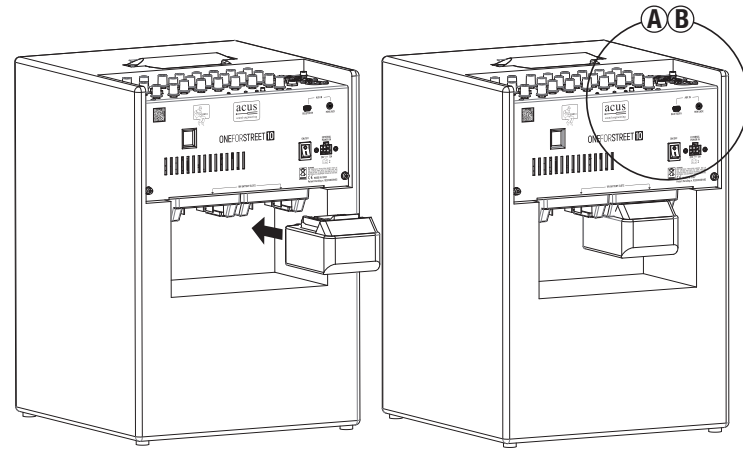

ONEFORSTREET 10 is not equipped with an inner power supply system. Is possible to power it with 2 types of source:

1. Battery (not included): insert the battery in the dedicated sled
2. External Power Supply (included): connect the power supply to the relative connector.

### COMPATIBILITY:

ACUS Sound Engineering SRL suggest the use of MAKITA 18V- 3 or 5 Ah.

### BATTERY POWERING:

The system has 4 operative status:

1. Battery Full: Battery Status LED (17) is OFF
2. Slightly Discharged Battery Status: Battery Status LED (17) starts to flash. In this status the LED ON Time is about 1/3 of LED Time OFF.
3. Very Low Battery Status: Battery Status LED (17) ON Time is the same of Time ON.
4. Completely Discharged Battery Status: Battery Status LED (17) if always ON and the system stops to work. In this status is necessary to replace the battery with another one full.

### WARNING:

1. Is important to recharge the battery as soon as possible.
2. Avoiding to let the ON/OFF Switch (22) when the system is not used because the system continue to absorb energy.
3. Avoid to let a totally discharged battery inserted because the system adsorbs a very little quantity of energy even with the ON/OFF Switch in the OFF position, and this fact (for a long time) will put the battery in a very low discharged status, reducing the battery life.

### EXTERNAL POWER SUPPLY POWERING.

The system works always in "Battery Full" status, so Battery Status LED (17) is always OFF.

### WARNING:

Is no possible to recharge a battery with the amplifier power supply.

## TOP SECTION

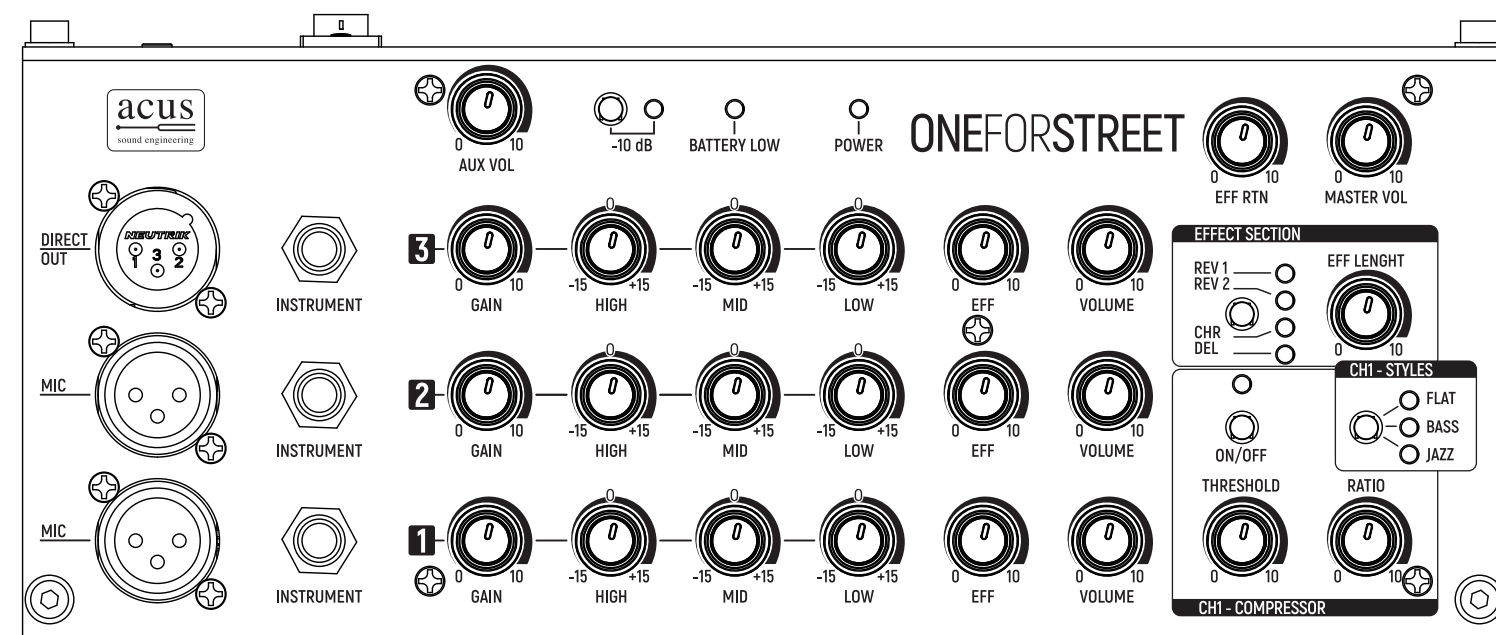

## REAR SECTION

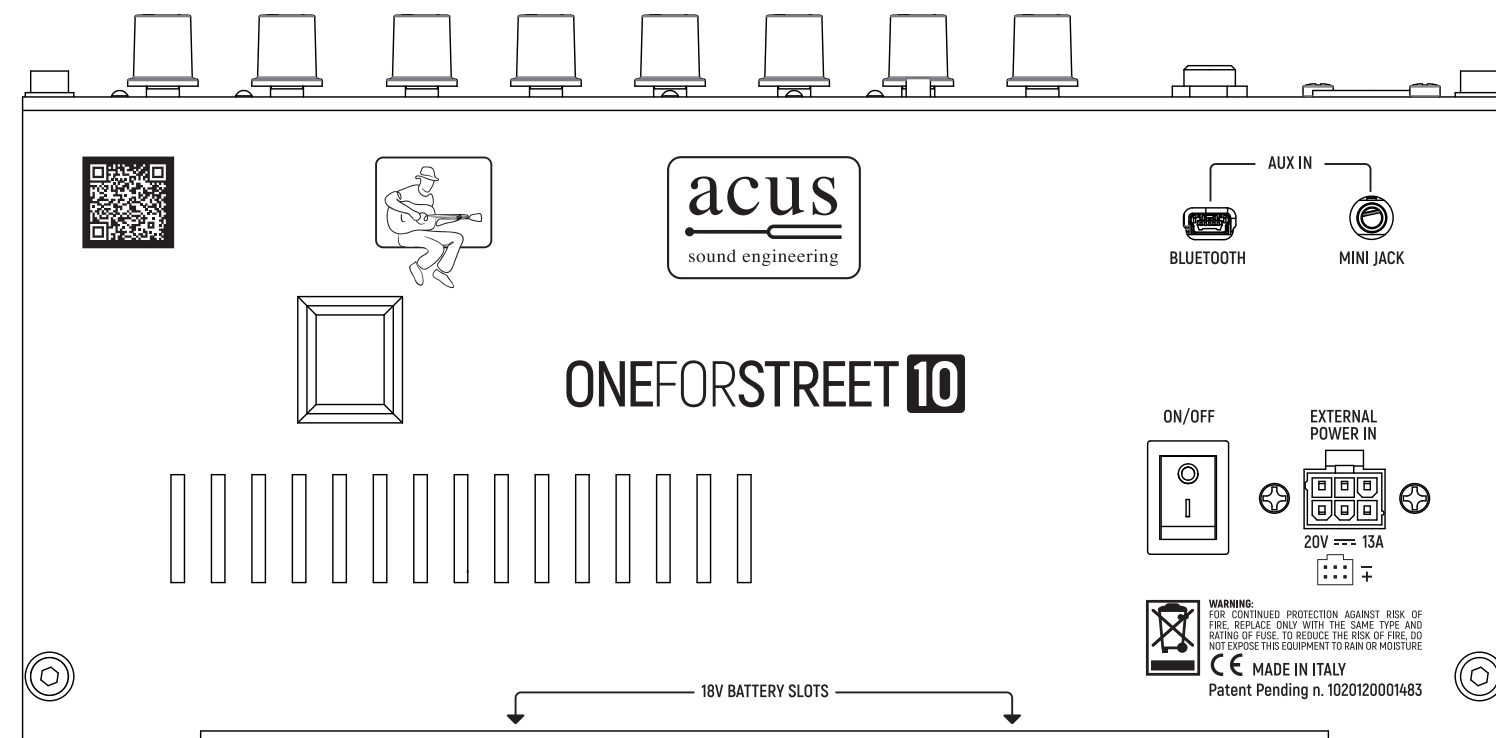

## CONTROLS

1. **MIC IN** with 1kΩ of Impedance. You can connect any type of microphone on it, even Condenser Microphone (this input is equipped with a Phantom power, always Active).
2. **INSTRUMENT IN** with 110kΩ of Impedance. You can connect any type of Instrument on it. This input doesn't exclude the MIC IN (1).
3. **GAIN**: this knob permits to regulate the gain of the system (its range is from -12 to +15dB).
4. **HIGH - MID - LOW**: 3 band EQ with a dynamic from -15dB to +15dB.
5. **EFF**: channel Effect Level. The system is equipped with a multi-effect. For detail see points (14) and (15).
6. **VOLUME**: channel Volume
7. **AUX VOL**: AUX IN (20) Inputs Volume.
8. **MASTER VOL**: Master Volume of the system.
9. **EFF RTN**: Return of the Effect of the system. When you close totally this knob (in the 0 position) you close the effect volume on all channels.
10. **CH1 - COMPRESSOR ON/OFF SWITCH**: the channel 1 is equipped with a compressor. This switch is for turning ON/OFF the compressor. When the compressor is ON its relative LED is ON.
11. **CH1 - COMPRESSOR THRESHOLD**: with this knob you can regulate the Ch1 Compressor Threshold if Ch1 Compressor ON/OFF is on ON position (Compressor LED ON).
12. **CH1 - COMPRESSOR RATIO**: with this knob you can regulate the Ch1 Compressor Ratio if Ch1 Compressor ON/OFF is on ON position (Compressor LED ON).
13. **CH1 - STYLES SWITCH**: with this switch is possible to change the channel 1 equalization and the 3 bands EQ center frequency. You have 3 position: FLAT is the standard equalization (channels 2 and 3 have only this type of equalization). BASS is designed for instruments that operate in bass frequency range (like Bass Guitar and Double Bass). JAZZ is for Electric Guitar and Jazz Guitar.
14. **EFFECT SECTION SWITCH**: with this switch is possible to select one of the 4 effect of the system. Effect are Short Reverb (REV 1), Long Reverb (REV 2), Chorus (CHR) and Delay (DEL).
15. **EFFECT SECTION EFF LENGTH**: with this knob is possible to change the peculiarity of the selected effect. For both reverb this knob regulates the Reverb Length. For Chorus this knob regulates the Chorus Rate. For Delay this knob regulates the Delay Time.
16. **POWER**: LED for indicating if the system is ON (Led ON) or OFF
17. **BATTERY STATUS**: LED for indicating the External Battery Status.
18. **-10dB**: pushing this switch will reduce the DIRECT OUT (19) signal level of 10dB. This attenuation condition is indicated with a LED.
19. **DIREC OUT**: balanced output for connecting the system with an External System.
20. **AUX IN**: section with 2 Inputs: a 3.5mm Jack and a mini-USB for ACUS Artesia BT-1 device. Both inputs are controlled with AUX VOL (7) knob.
21. **EXTERNAL POWER IN**: connector for the External Power Supply (Included)
22. **ON/OFF**: Power Switch for Turning-ON / OFF the system.
23. **18V BATTERY SLOTS**: slot connection for powering the system with the external battery (not included).

## SMART ACCESSORIES

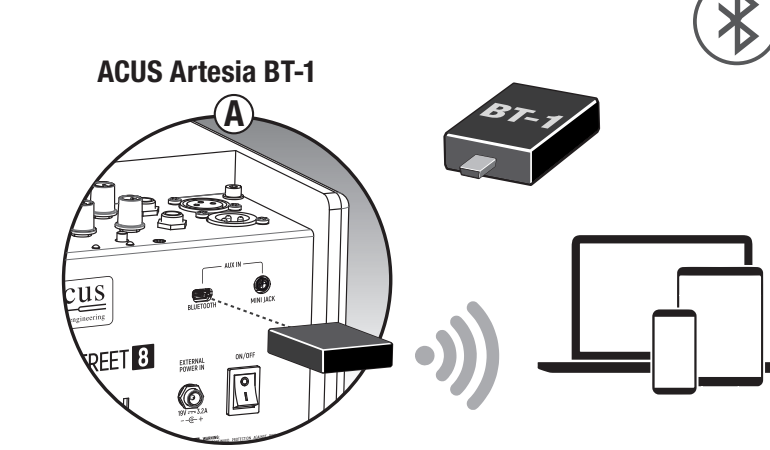

1. Make sure that the amplifier is powered off and connect the ACUS Artesia BT-1 Bluetooth Receiver to mini-USB AUX IN connector.
2. Turn the amplifier on. The ACUS Artesia BT-1 Bluetooth Receiver blue LED indicator lamp should flash quickly. This lasts for about 5 seconds. Then it will flash again every 7 seconds until it matches (or pair) successfully with another Bluetooth device.
3. After it has matched successfully, find ACUS Artesia BT-1 as an option on your Bluetooth Device's Settings and then select it to connect.
4. When the blue LED indicator lamp on the ACUS Artesia BT-1 Bluetooth Receiver is ON steady with no flashing, then the two devices have been successfully connected.

### ACUS Artesia LS-1 - TRRS ADAPTER for your live streaming

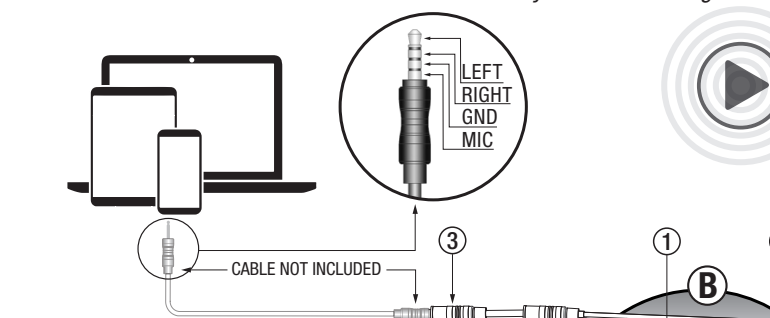

1. 3.5 mm Right-Angle Stereo Plug: connect to AUX IN input.
2. 3-Pole XLR Female Connector: connect to DIRECT OUT output.
3. 3.5 mm TRRS Jack Connector: connect to recording /reproduction device used for your Live Streaming with a 3.5mm TRRS Plug to Plug cable (not included).

**Suggestions:** for obtaining better configuration is very important to have a moderate volume to the amplifier DIRECT OUT output. If the amplifier is equipped with the attenuation switch (labeled with -10dB) push this switch for a very easy and fast signal level matching. If the amplifier is not equipped with this switch, for best configuration please reduce all channel volume more than half and then regulate the amplifier master volume for obtaining the right sound to the speaker.

## TECHNICAL INFORMATION

Frequency Response:	40Hz - 20kHz
Max Power Out:	120W
System Format:	2 way Amp
Woofer Power:	100W
Tweeter Power:	20W
Construction:	Brich Plywood Cabinet
Weight:	11 kg
Dimensions (WxHxD)	302x425x310 mm

### N.B.

For more information you can download the complete ONEFORSTREET 10 manual from the company web site.

ACUS empfiehlt die Produkte von Makita zu verwenden



Battery Charge Station



DC18RC

Battery Li-ion 18V 3.0Ah



BL1830B

Battery Li-ion 18V 5.0Ah



BL1850B

Battery Li-ion 18V 6.0Ah



BL1860B



All the showed batteries work with the our amplifiers, the nominal capacity will determinate the operative time.

Manufacturing laboratory test:

BL 1830B - LI-ION - 18V - 3.0Ah  
ONEFORSTREET 5 one battery is 7HRS  
ONEFORSTREET 8 one battery is 2HRS, two batteries 4HRS  
ONEFORSTREET10 one battery is 2HRS, two batteries 4HRS

BL 1850B - LI-ION - 18V - 5.0Ah  
ONEFORSTREET 5 one battery is 10HRS  
ONEFORSTREET 8 one battery is 3HRS, two batteries 6HRS  
ONEFORSTREET10 one battery is 3HRS, two batteries 6HRS

BL 1860B - LI-ION - 18V - 6.0Ah  
ONEFORSTREET 5 one battery is 14HRS  
ONEFORSTREET 8 one battery is 4HRS, two batteries 8HRS  
ONEFORSTREET10 one battery is 4HRS, two batteries 8HRS